



EXIT



3RD FLOOR, 1 FINSBURY SQUARE, LONDON, EC2A 1AE

7,238 SQ FT



24/7 Manned Reception



Plug & Play



Cycle Storage and
Showers



Client Facing
Meeting Rooms
and an Extensive
Boardroom



Great Levels of Natural
Light with Views over
Finsbury Square



Large Kitchen and
Breakout

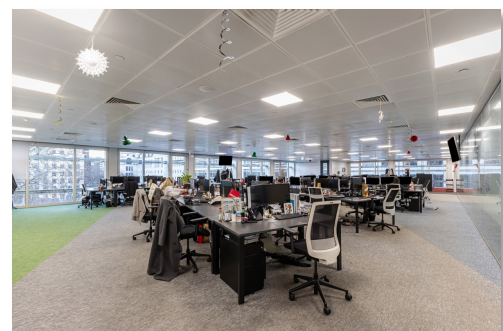

VIEW NOW 07471 998225 OR 07551 158799

info@makingmoves.london

www.makingmoveslondon.co.uk



DESCRIPTION

The office is fully fitted with high-quality furniture and benefits from excellent natural light throughout. A range of meeting rooms includes two interconnecting boardrooms, which can be opened via a concertina wall to create a larger space suitable for 40–50 people.

The building features a well-presented, newly refurbished, manned reception, along with secure cycle storage and shower facilities.

The column-free floorplate offers an efficient and highly flexible workspace, complemented by impressive views over Finsbury Square.



TERM

Available by way of an Assignment or a Sub-lease with a term expiring on the 13th July 2027.

A new Lease is also available with the Landlord.

This office is also available Managed.



LOCATION

1 Finsbury Square occupies an exceptional City location with outstanding transport connectivity.

Positioned directly above Moorgate Station and moments from Liverpool Street, the building provides immediate access to the Elizabeth line, Underground, National Rail and mainline services, making it one of the best-connected office addresses in London.

The surrounding area offers a vibrant mix of cafés, restaurants and bars, along with green open space at Finsbury Square, providing excellent options for meetings, lunch breaks and after-work socialising.

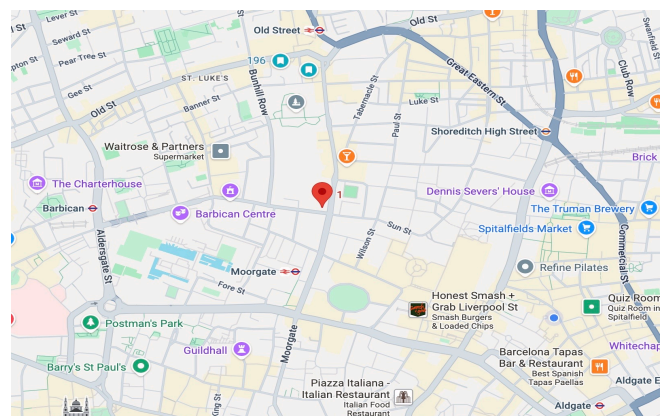

Floor	Size (sqft)	Quoting Rent	Service Charge	Business Rates	Total (pa)	Total (pcm)
3 rd Floor	7,238	£67.50	£22.92	£24.52	£831,936	£69,328



GEORGE MARMENT

Email: gpm@makingmoves.london

Tel: 07551 158 799



RACHEL STEAD

Email: rachel.stead@makingmoves.london

Tel: 07471 998 225



EXIT





EXIT



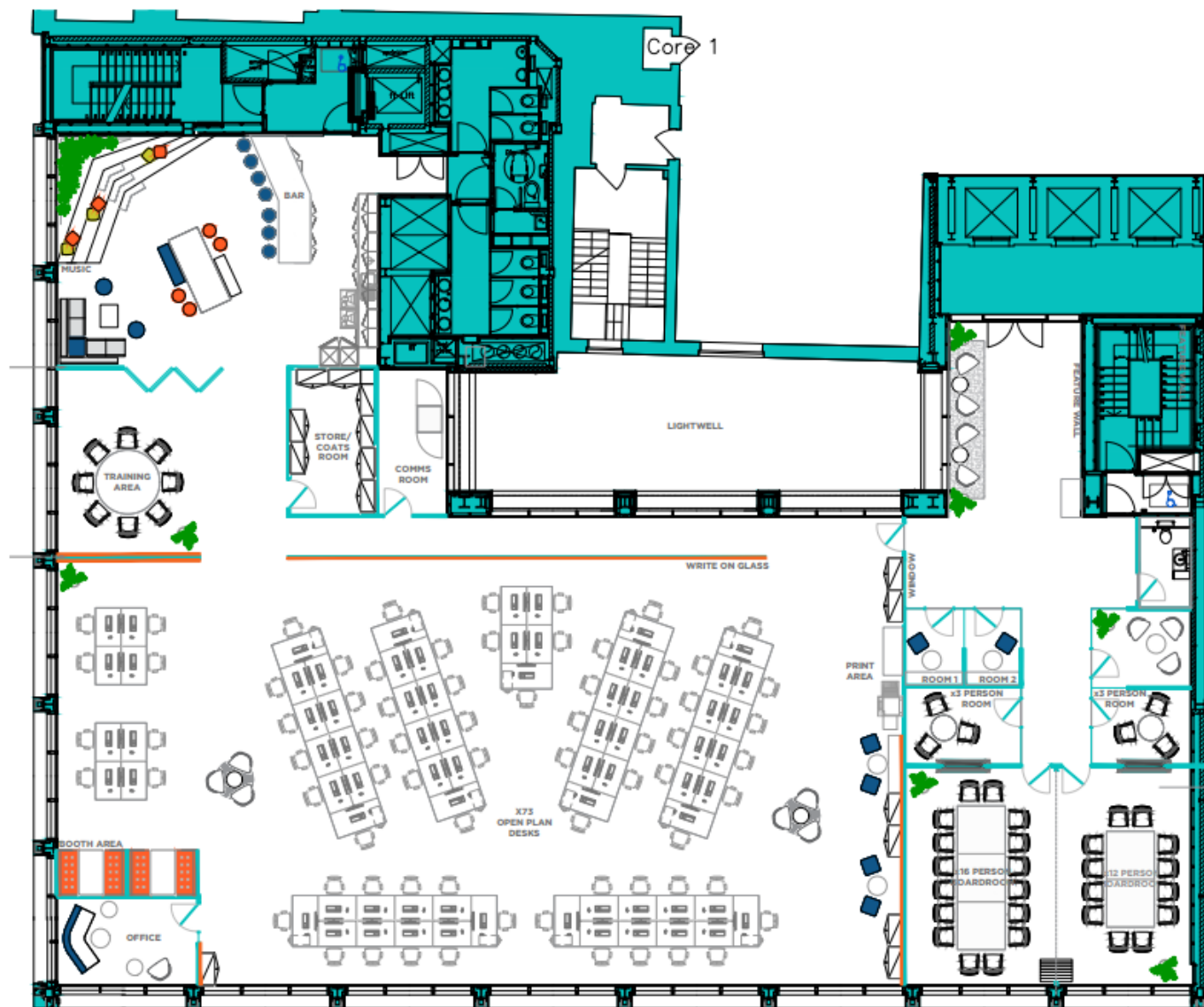



MAKING MOVES

HEAD OFFICE

8 Devonshire Square,
London,
EC2M 4PL

WEST END

Mortimer House,
Fitzrovia,
London, W1T 3JH

TEL 020 3595 3121

E-MAIL info@makingmoves.london

WEB www.makingmoveslondon.co.uk